

PRODEMAND

YMMS: 2007 Pontiac Solstice GXP

Engine: 2.0L Eng

VIN:

May 31, 2021

License:

Odometer:

Fuel Pump Module Replacement

Tools Required

J 45722 Fuel Sender Lock Ring Wrench. See Special Tools.

Removal Procedure

CAUTION: *In order to reduce the risk of fire and personal injury that may result from a fuel leak, always replace the fuel sender gasket when reinstalling the fuel sender assembly.*

NOTE: *Cap the fittings and plug the holes when servicing the fuel system in order to prevent dirt and other contaminants from entering the open pipes and passages.*

1. Relieve the fuel system pressure. Refer to Fuel Pressure Relief.

Fig 3: Fuel Sending Unit Access Cover

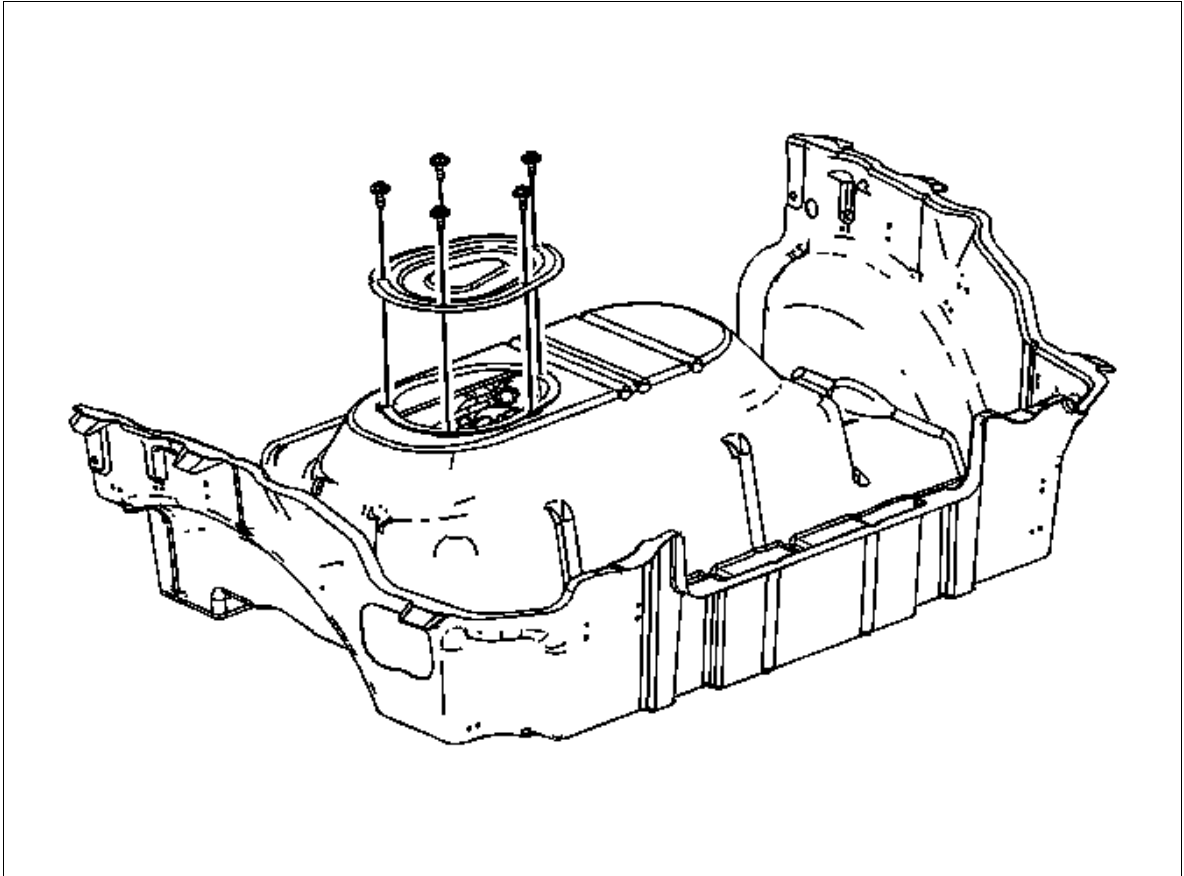

Courtesy of GENERAL MOTORS CORP.

2. Remove the rear compartment trim panel. Refer to Rear Compartment Trim Panel Replacement .
3. Remove the fuel pump module access cover bolts.
4. Remove the access cover.
5. Disconnect the fuel sender electrical connector (3).

Fig 4: Fuel Sending Unit Electrical Connector

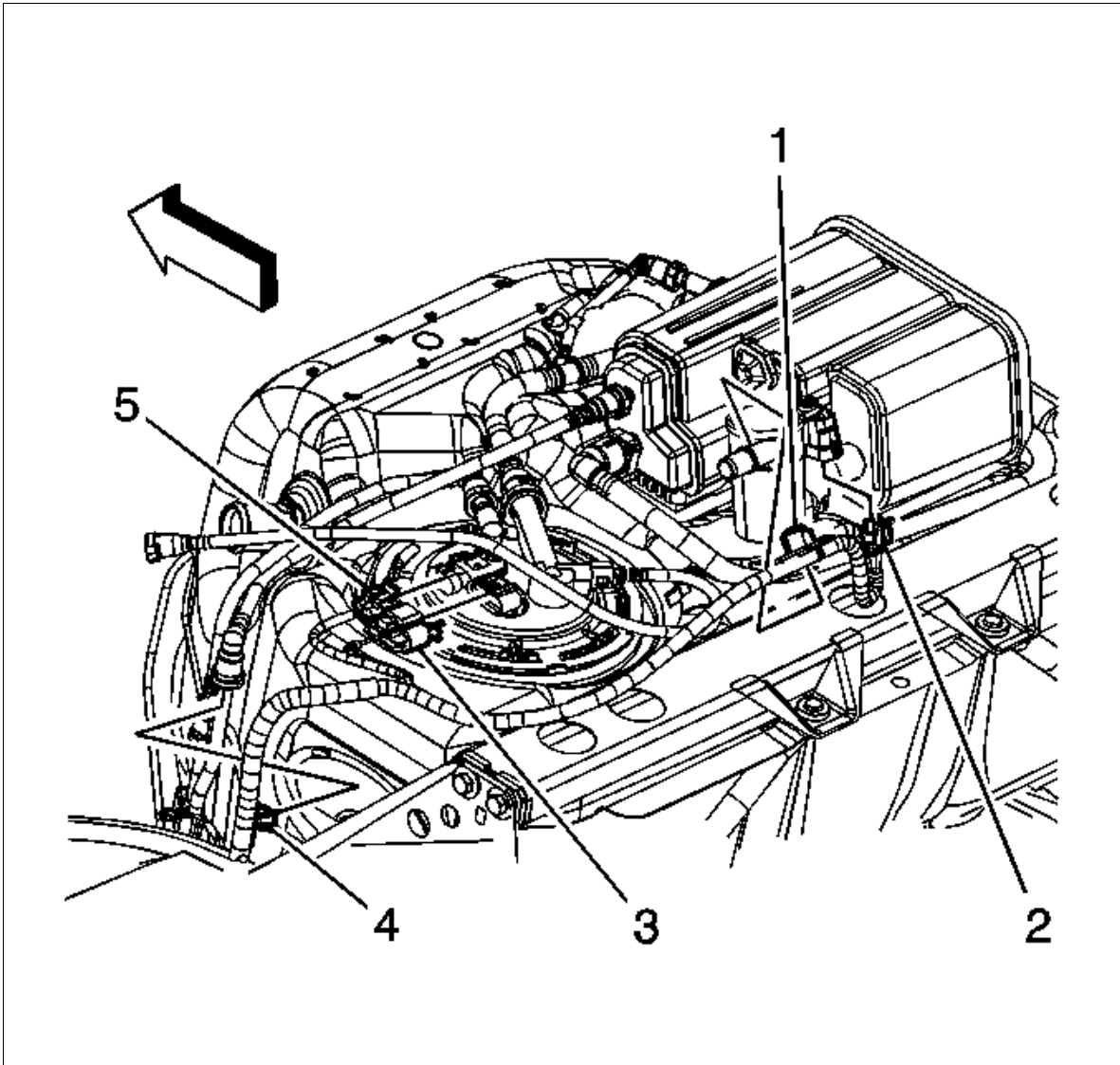

Courtesy of GENERAL MOTORS CORP.

6. Disconnect the fuel pressure sensor electrical connector (5).
7. Disconnect the fuel fill pipe evaporative emission (EVAP) pipe quick connect fitting (1). Refer to Plastic Collar Quick Connect Fitting Service.

Fig 5: Fuel Feed Pipe Quick Connect Fitting

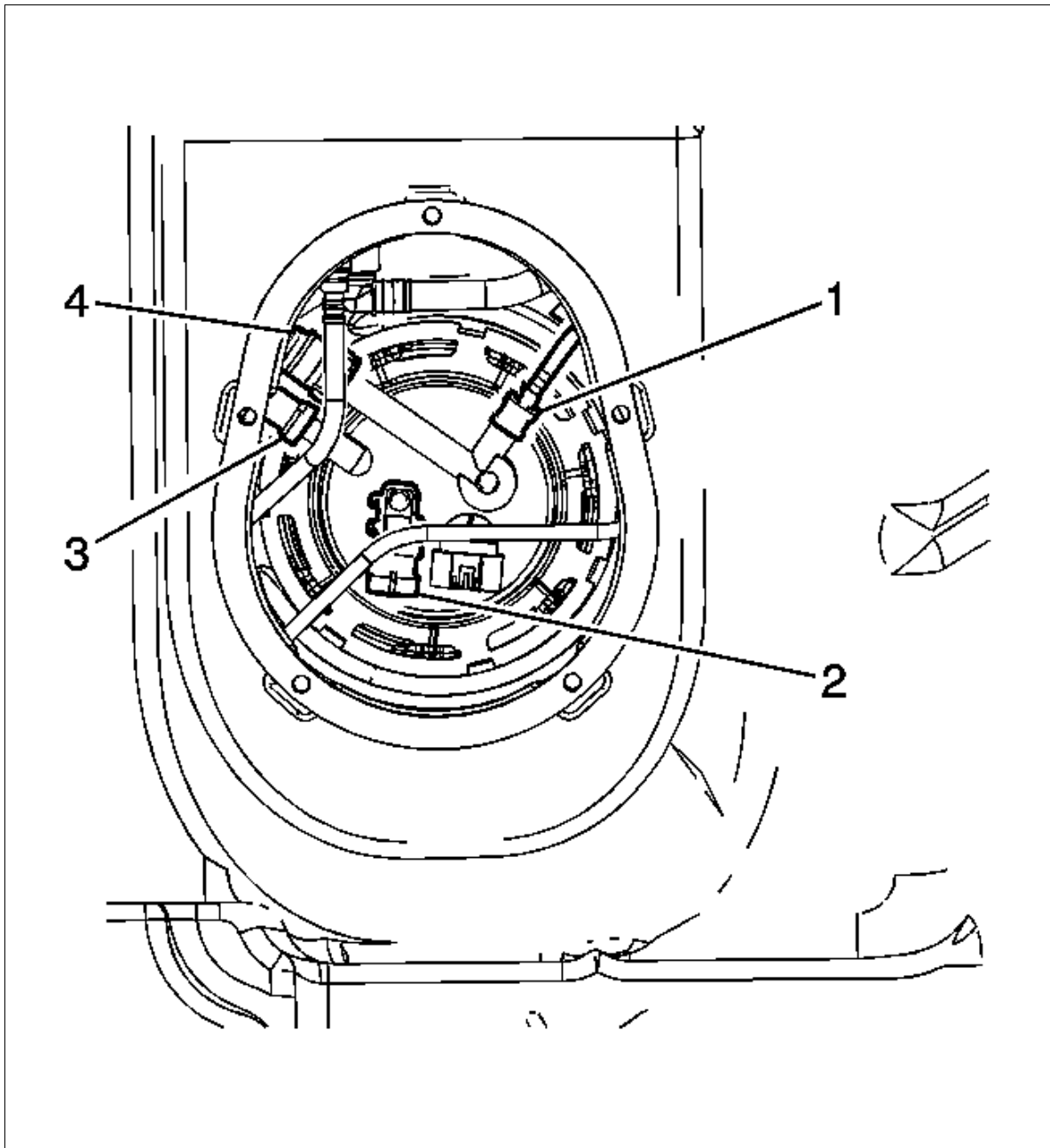

Courtesy of GENERAL MOTORS CORP.

8. Disconnect the fuel feed pipe quick connect fitting (1). Refer to Plastic Collar Quick Connect Fitting Service.
9. Use the **J 45722** and a long breaker-bar in order to unlock the fuel sender lock ring. See Special Tools. Turn the fuel sender lock ring in a counterclockwise direction.

Fig 6: Identifying Lock Ring

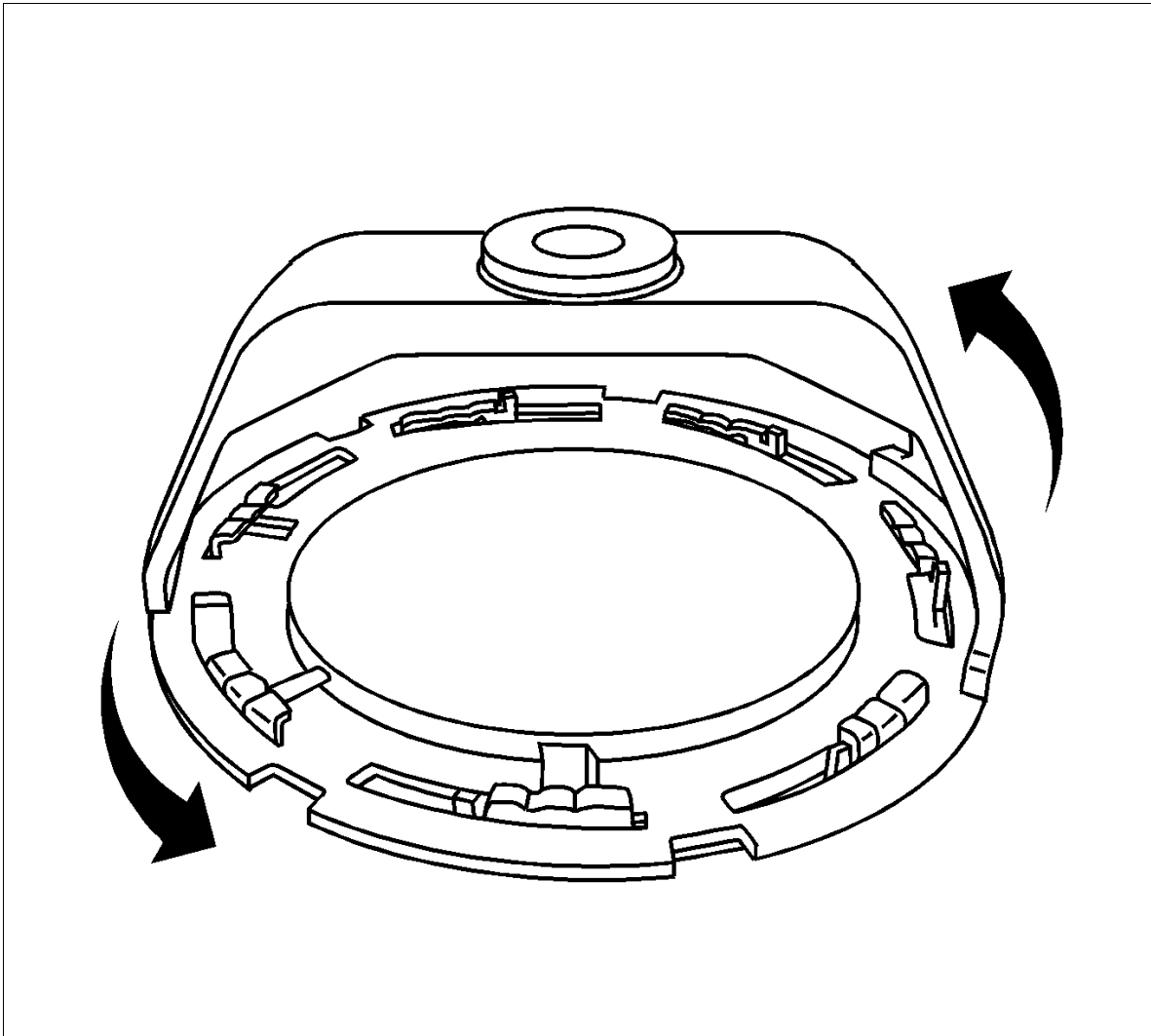

Courtesy of GENERAL MOTORS CORP.

NOTE: Avoid damaging the lock ring. Use only J-45722 to prevent damage to the lock ring.

NOTE: Do Not handle the fuel sender assembly by the fuel pipes. The amount of leverage generated by handling the fuel pipes could damage the joints.

IMPORTANT:

1. The fuel sender assembly may spring up from its position.
2. When removing the fuel sender assembly from the

fuel tank, be aware that the reservoir bucket is full of fuel. It must be tipped slightly during removal to avoid damage to the float. Discard the fuel sender assembly O-ring and replace it with a new one.

3. *Carefully discard the fuel in the reservoir bucket into an approved container.*

IMPORTANT: *Do NOT use impact tools. Significant force will be required to release the lock ring. The use of a hammer and screwdriver is not recommended. Secure the fuel tank in order to prevent fuel tank rotation.*

10. Raise the fuel sender up slightly.

Fig 7: Fuel Sender Assembly

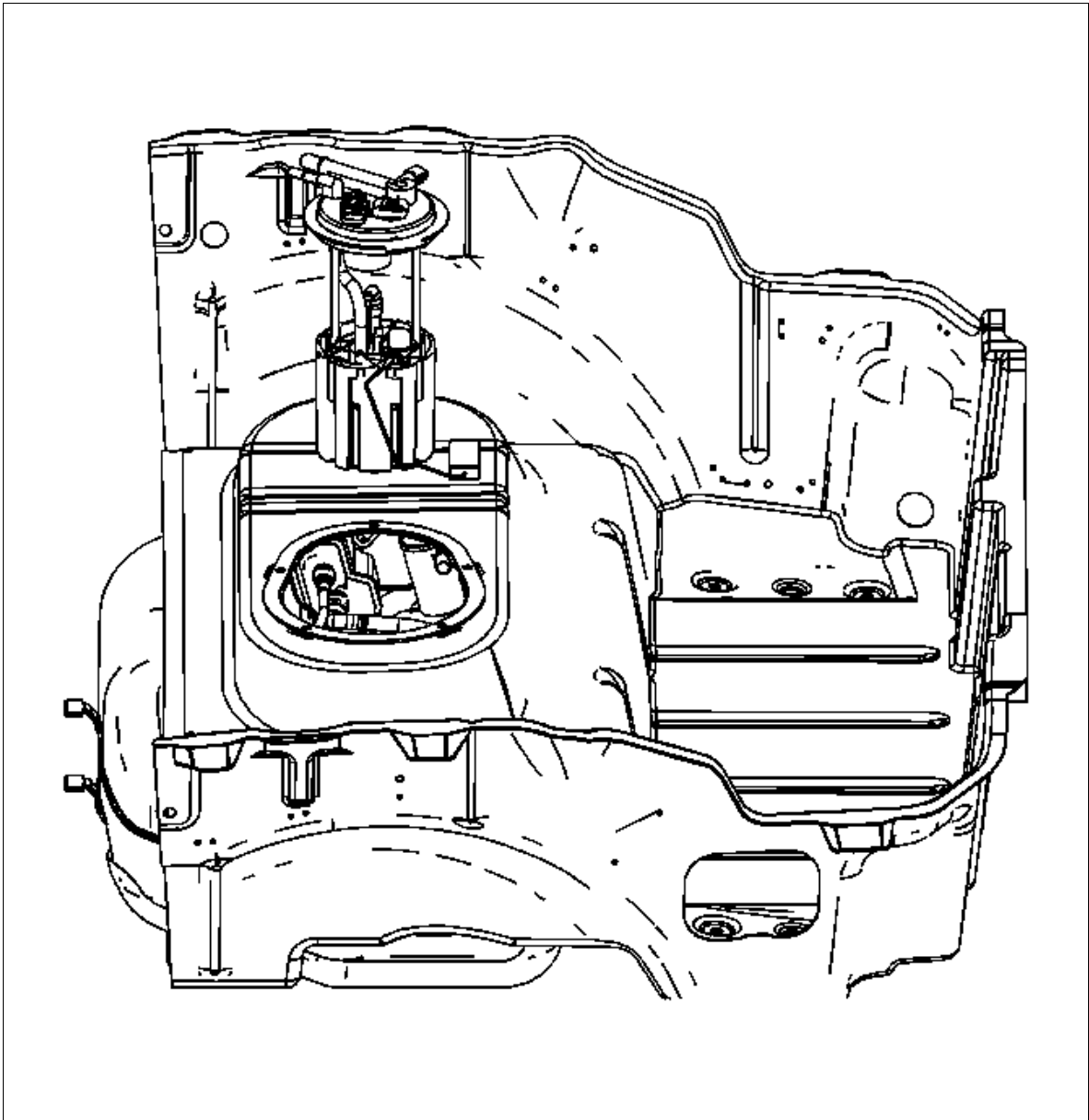

Courtesy of GENERAL MOTORS CORP.

11. Connect the large EVAP canister quick connect fitting. Refer to Plastic Collar Quick Connect Fitting Service.
12. Remove the fuel sender assembly.
13. Remove and discard the fuel sender O-ring.
14. Place the lock ring on a flat surface. Measure the clearance between to lock ring and the flat surface using a feeler gage at 7 points.

Fig 8: Checking Lock Ring For Flatness

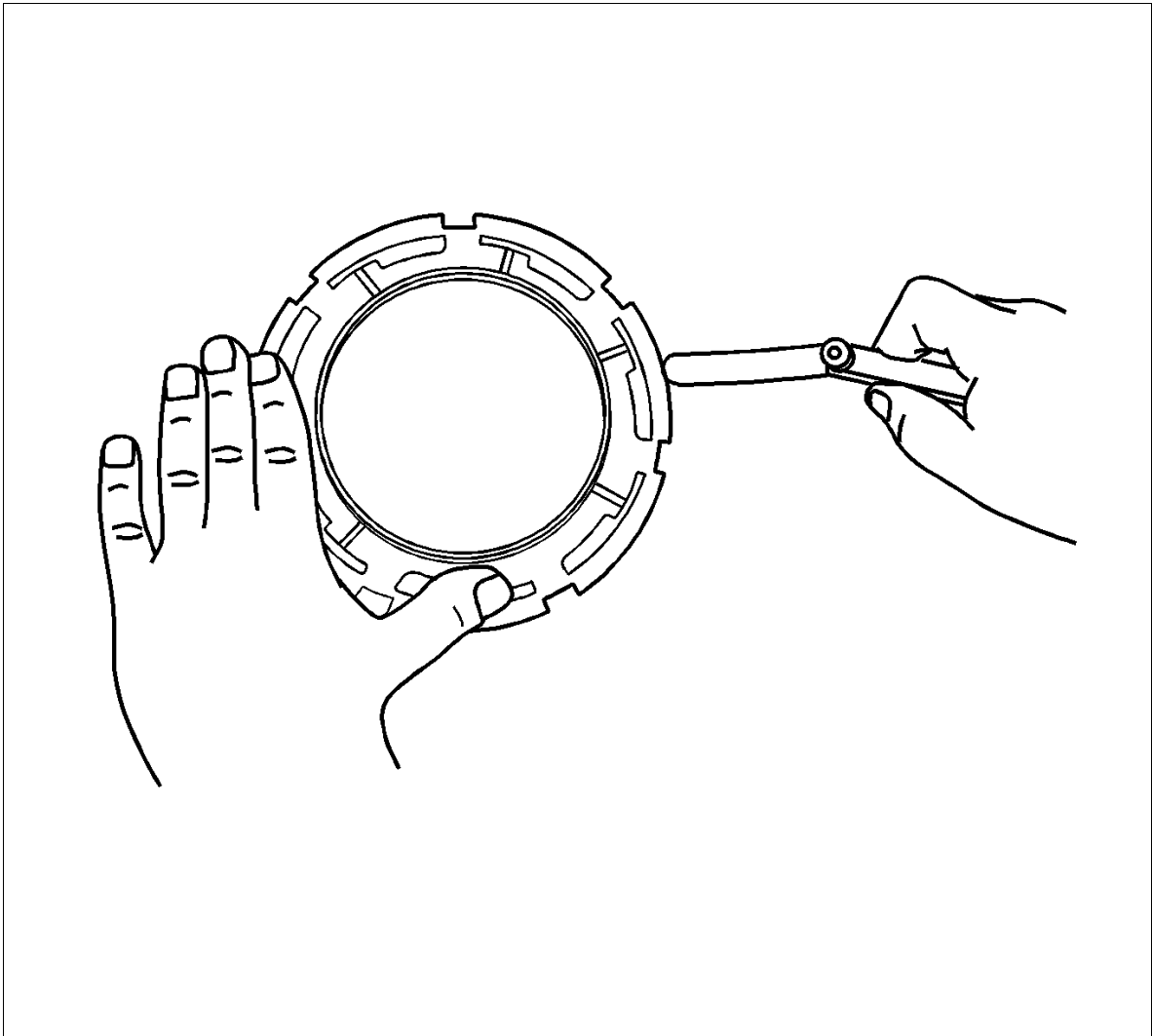

Courtesy of GENERAL MOTORS CORP.

IMPORTANT:

1. Some lock ring were manufactured with *DO NOT REUSE* stamped into them. These lock rings may be reused if they are not damaged or warped.
2. Inspect the lock ring for damage due to improper removal or installation procedures. If damage is found, install a *NEW* lock ring.
3. Check the lock ring for flatness.

15. If the warpage is less than 0.41 mm (0.016 in), the lock ring does not require replacement.

16. If the warpage is greater than 0.41 mm (0.016 in), the lock ring must be replaced.

Installation Procedure

1. Install a *NEW* fuel sender O-ring.

Fig 9: Fuel Sender Assembly

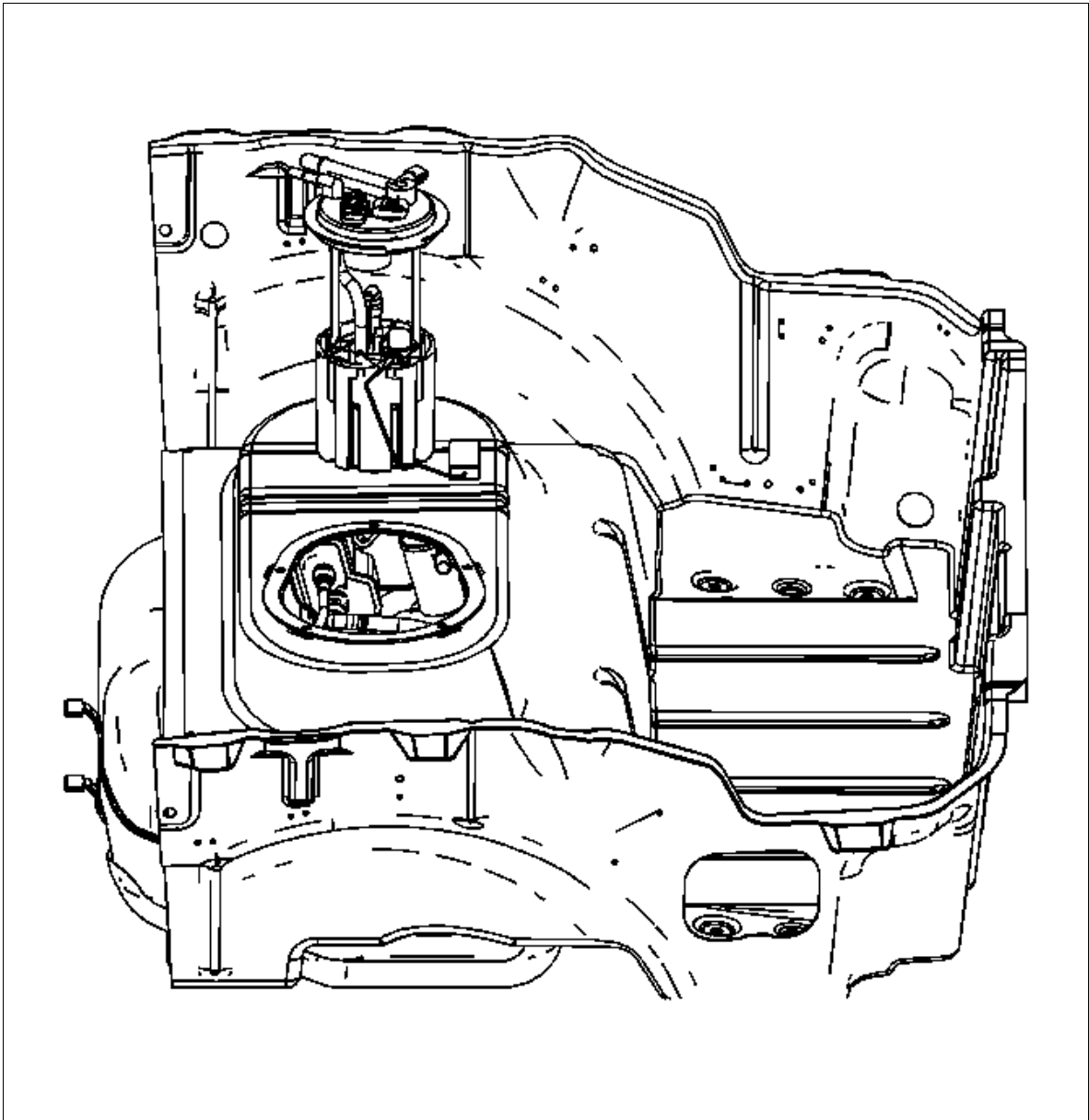

Courtesy of GENERAL MOTORS CORP.

2. Install the fuel sender assembly.
3. Using the **J 45722** , rotate the fuel sender assembly lock ring clockwise until the ring is locked into place on the fuel tank. See Special Tools.

Fig 10: Identifying Lock Ring

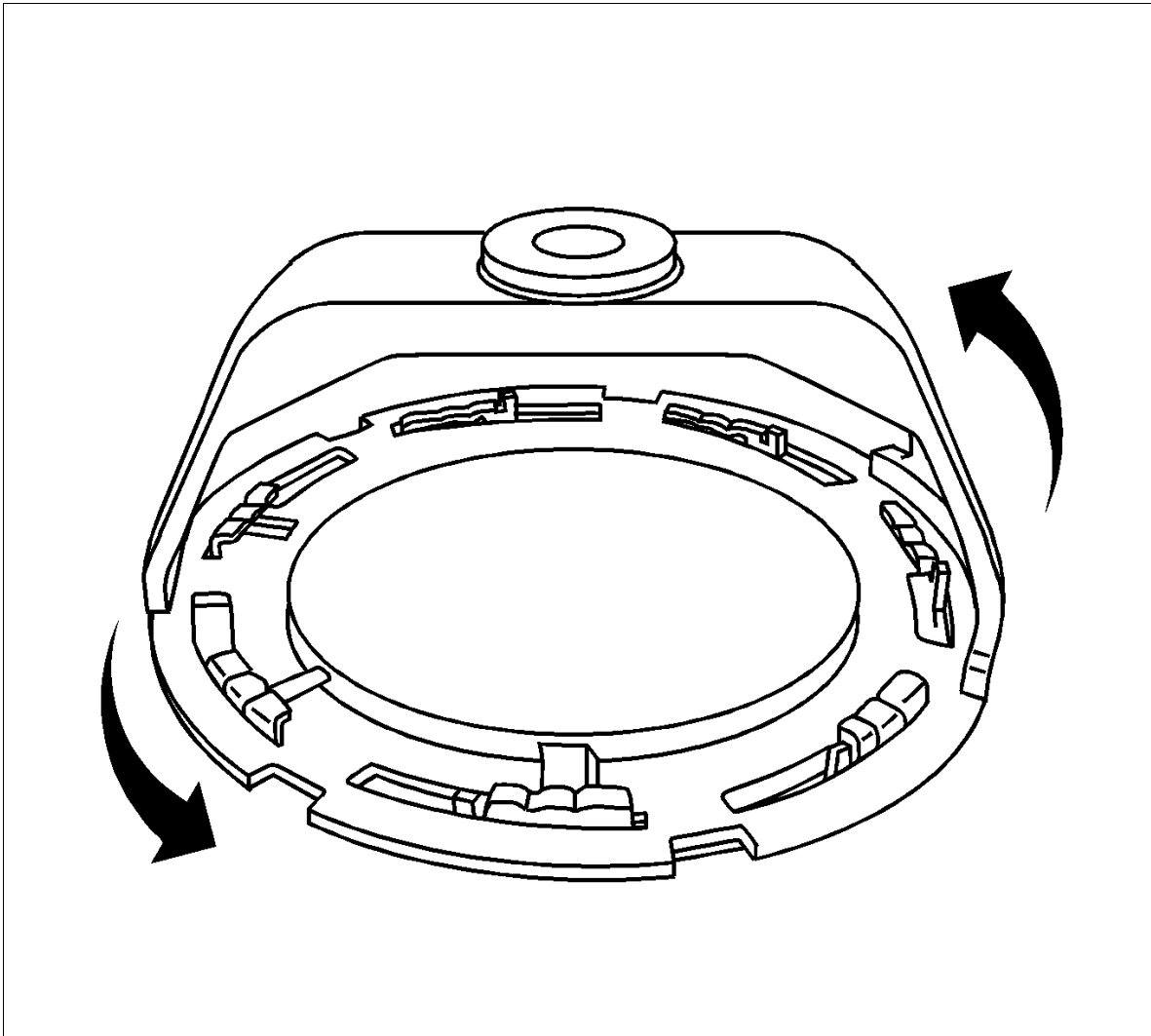

Courtesy of GENERAL MOTORS CORP.

IMPORTANT: Always replace the fuel sender seal when installing the fuel sender assembly. Replace the lock ring if necessary. Do not apply any type of lubrication in the seal groove. Ensure the lock ring is installed with the correct side facing upward. A correctly installed lock ring will only turn in a clockwise direction.

4. Connect the large EVAP canister quick connect fitting. Refer to Plastic Collar Quick Connect Fitting Service .
5. Connect the fuel feed pipe quick connect fitting (1). Refer to Plastic Collar Quick Connect Fitting Service.

Fig 11: Fuel Feed Pipe Quick Connect Fitting

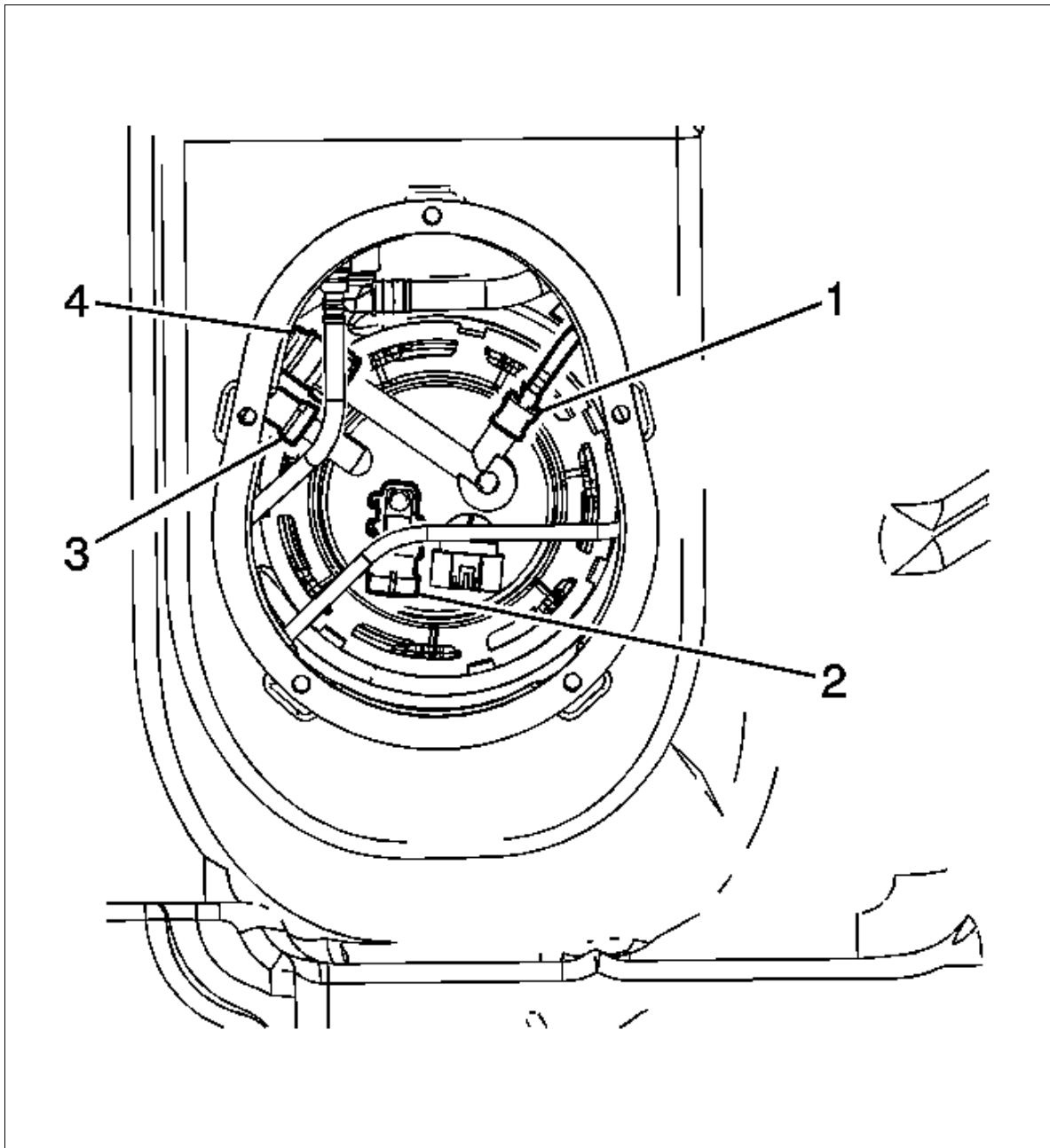

Courtesy of GENERAL MOTORS CORP.

6. Connect the fuel fill pipe EVAP pipe quick connect fitting (1). Refer to Plastic Collar Quick Connect Fitting Service.
7. Connect the fuel pressure sensor electrical connector (5).

Fig 12: Fuel Sending Unit Electrical Connector

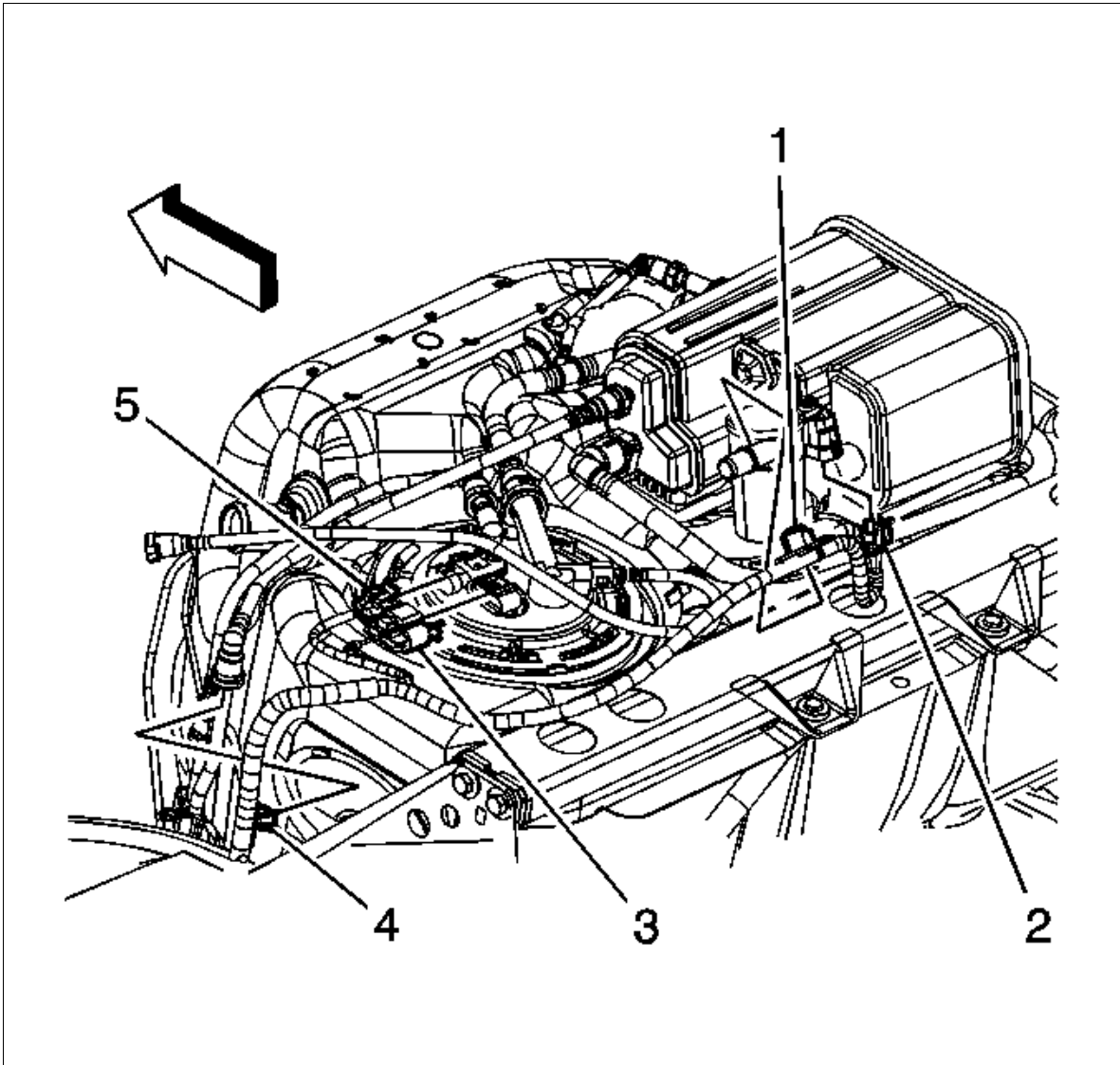

Courtesy of GENERAL MOTORS CORP.

8. Connect the fuel sender electrical connector (3).
9. Install the access cover.

Fig 13: Fuel Sending Unit Access Cover

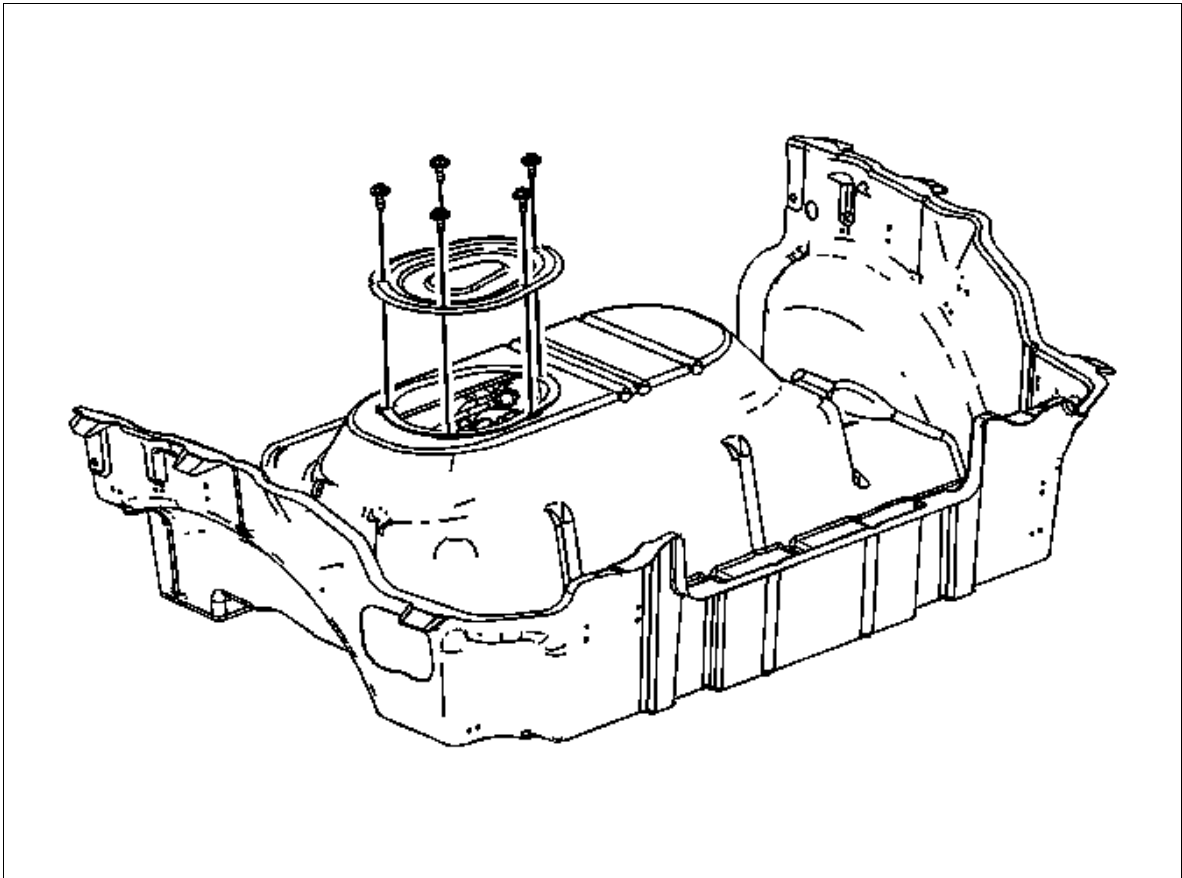

Courtesy of GENERAL MOTORS CORP.

10. Install the fuel pump module access cover bolts.

Tighten: Tighten the bolts to 10 N.m (89 lb in).

11. Install the rear compartment trim panel. Refer to Rear Compartment Trim Panel Replacement .

12. Refill the tank.

13. Connect the negative battery cable. Refer to Battery Negative Cable Disconnection and Connection .

14. Inspect for fuel leaks through the following steps:

1. Turn the ignition to the ON position for 2 seconds.
2. Turn the ignition to the OFF position for 10 seconds.
3. Turn the ignition to the ON position.
4. Check for fuel leaks.